



353 Riley Street SURRY HILLS NSW

7 🚗 2 🚗 1 🚗

For Sale/Expressions of Interest

Huge opportunity to work/live in the beautiful Victorian Terrace that has been fitted out with the latest trimmings.

Zoned for commercial/residential usage. It is set up over four levels with crispy white walls, dark blue carpet, opulent finishings, abundance of natural light and a set up recording studio downstairs.

- Air conditioning, Miele appliances, back to base security system
- Spacious rear terrace with plenty of room for entertaining
- Close to all of Sydney's finest restaurants and cafes
- Single lock up garage with loads of storage space
- Entrances from the front and back.

Building Size : 15 sqm
View : <https://www.the-edge.com.au/sale/nsw/eastern-suburbs/surry-hills/residential/terrace/5824742>

LOWER LEVEL

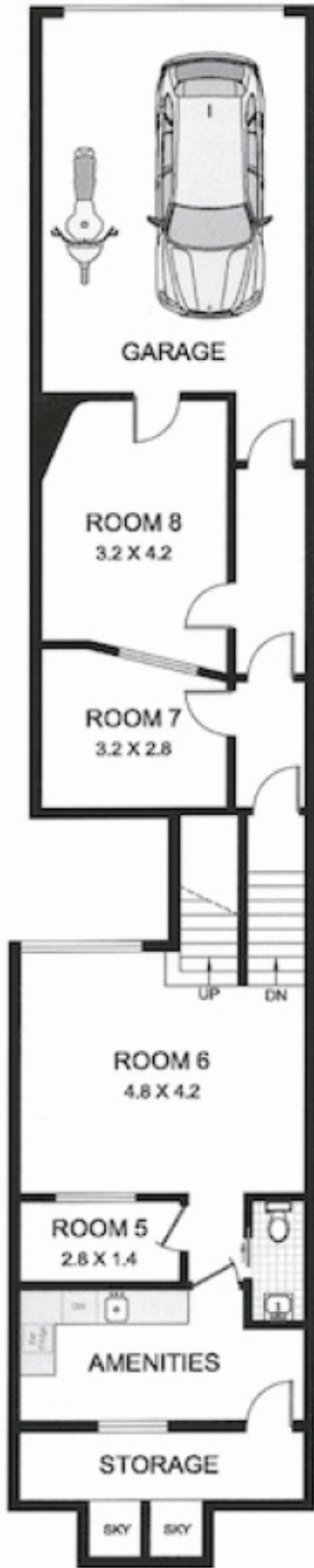

ENTRY LEVEL

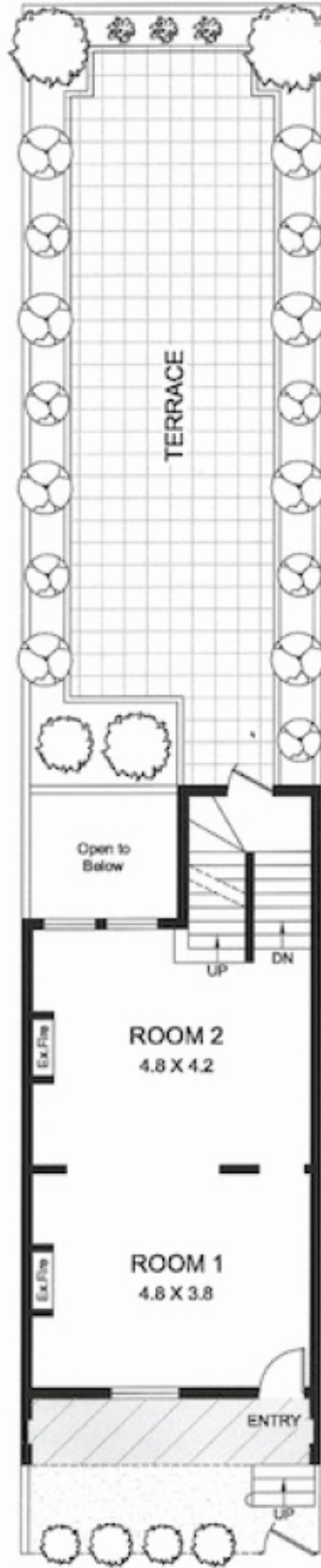

UPPER LEVEL

