



## 89 Gilderthorpe Avenue Randwick NSW

Offering both immediate income and huge potential to improve and develop. This is a rare opportunity to secure this prime asset in a proven location.

Occupying the corner of Gilderthorpe Ave and Hooper Lane, the property is seated on 679 sqm of level land.

Currently consisting of 4 apartments, this property is ideal for improvement and development.

### FEATURES INCLUDE

- 2 x 3 bedroom apartments
- 2 x 1 br plus study/second bedroom apartments
- Laundry
- Vacant land at the rear of the building

### DEVELOPMENT INFORMATION:

- Height limit of 12 meters
- FSR of .9:1

[For full version visit the website](#)

**Type** : Development  
**Land Size** : 679 sqm  
**View** : <https://www.the-edge.com.au/sale/nsw/east-ern-suburbs/randwick/commercial/development/5825117>



**Achilles Peshos**  
02 9267 9832



This Floor Plan was prepared by WWW.CRYINGOUTLOUD.COM.AU for illustration purposes only. This document does not constitute any part of an offer or contract. Dimensions are approximate only. Copyright © 2017 Crying Out Loud. All Rights Reserved.

4/89 Gilderthorpe Ave, Randwick

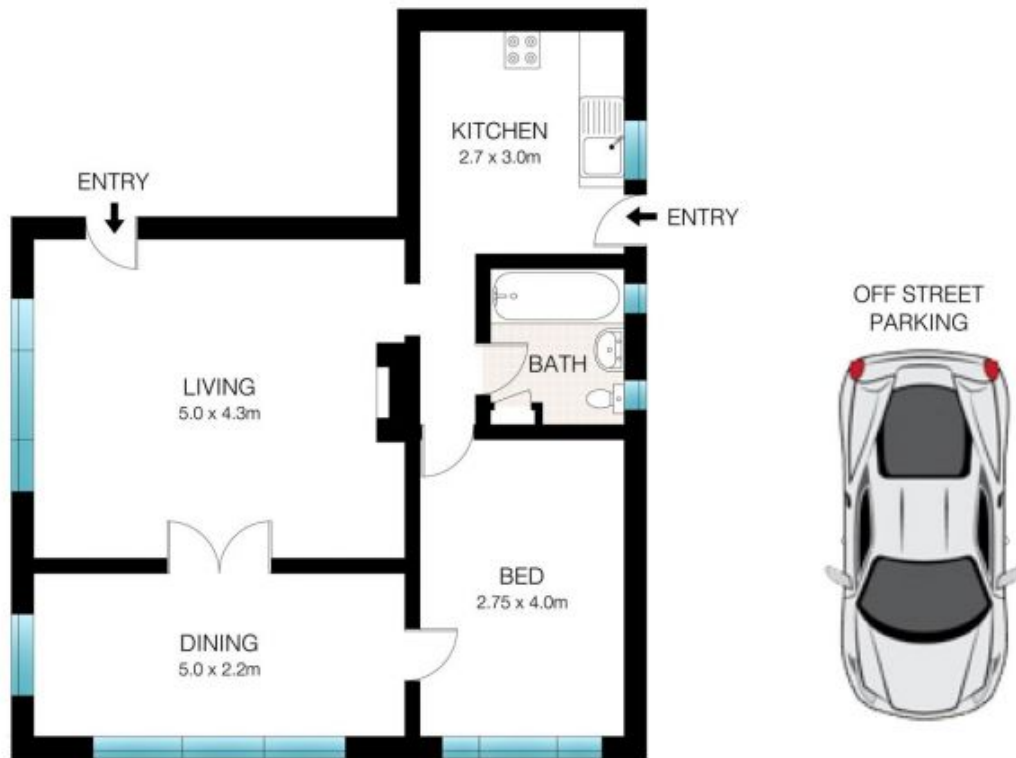

INT: 61.0m<sup>2</sup>

This Floor Plan was prepared by WWW.CRYINGOUTLOUD.COM.AU for illustration purposes only. This document does not constitute any part of an offer or contract. Dimensions are approximate only. Copyright © 2017 Crying Out Loud. All Rights Reserved.